

1 Building 04 - NE Elevation - Courtyard Elevation
1:100



3 Building 04 - NW Elevation - Kilmacud Road
1:100



2 Building 04 - SW Elevation
1:100



4 Building 04 - SE Elevation - Courtyard
1:100

Building 04 Elevations

- Materials Legend**
- 1 Selected Coloured Render 1
 - 2 Selected Coloured Render 2
 - 3 Selected Brick Finish
 - 4 Selected Buff Brick
 - 5 Selected Buff Brick 2
 - 6 Aluminium Frame (Balcony)
 - 7 Aluminium Frame (Bronze)
 - 8 Selected Glazing
 - 9 Selected Aluminium Metal Panel (Dusty Gold)
 - 10 Aluminium Frame
 - 11 Aluminium Frame (Dark)

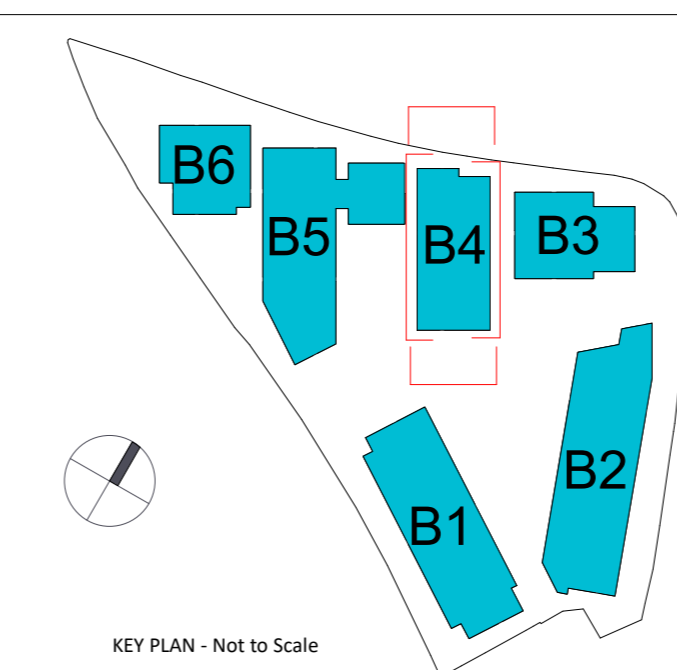

Revision Description	Date	Rev. No.	Issued by
Issued For Planning	29-03-2022	1	PK

o'mahony pike

architecture | urban design | Dublin | Cork
 email: info@omahonypike.com | The Chapel | One South Mall
 tel: +353 1 202 7400 | Mount St. Anne's | Cork City
 fax: +353 1 283 0822 | Milltown, Dublin 6 | Co. Cork
 www.omahonypike.com | 000 NWS Ireland | T12 CCN3 Ireland

Project: Blakes Esmonde SHD
Location: Stillorgan
Client: Cairn Homes Properties Ltd

Project Code: 1702A
Project Lead: MH/PS
Drawn By: PK
Job No.: 1702A
Purpose: Planning

Scale @ A0: 1:100
Date: 29-03-2022
Revision: 1
Status: SO

Drawing Title: Building 04 Elevations
Drawing No.: 1702A-OMP-ZZ-ZZ-DR-A-2011