

This drawing should not be scaled. Dimensions to be verified on site. Any discrepancies should be referred to the Engineer prior to work being put in hand.

GENERAL NOTES

- DO NOT SCALE. USE FIGURED DIMENSIONS ONLY.
- THIS DRAWING IS TO BE READ IN CONJUNCTION WITH ALL OTHER RELEVANT ARCHITECTURAL AND ENGINEERING DRAWINGS.
- ALL STRUCTURAL CONCRETE TO BE GRADE C32/40 MIN. WITH 10mm MAX. AGGREGATE SIZE TYPE XA3 IN CONTACT WITH GROUND, UNLESS NOTED OTHERWISE.
- COVER TO REINFORCEMENT BELOW GROUND LEVEL TO BE 75mm WITHOUT BLINDING OR SHUTTERING.
- REINFORCEMENT TO COMPLY WITH B.S. 8666:2005 AND TO BE AS FOLLOWS:
 - H - GRADE B500A, GRADE B500B OR GRADE B500C CONFORMING TO BS 4449:2005
 - A - GRADE B500A CONFORMING TO BS 4449:2005
 - B - GRADE B500B CONFORMING TO BS 4449:2005
 - C - GRADE B500C CONFORMING TO BS 4449:2005
- ALL STRUCTURAL STEELWORK TO BE GRADE S275 TO B.S. EN 10025.
- THE DETAILS OF ALL WELDING CONNECTIONS SHOULD COMPLY WITH B.S. 5135.
- FULL WORKSHOP DETAILS FOR ALL STRUCTURAL STEEL ELEMENTS ARE TO BE SUBMITTED TO THE ENGINEER FOR APPROVAL INCLUDING DESIGN CALCULATIONS FOR CONNECTIONS.
- ALL BOLTED JOINT CONNECTIONS TO BE BY MEANS OF GRADE 8.8 BOLTS TO B.S. 9992.
- THE CONTRACTOR IS TO INCLUDE FOR TESTING OF WORKSHOP WELDS AND SITE WELDS IN ACCORDANCE WITH THE REQUIREMENTS OF THE SPECIFICATION.
- ALL BLOCKWORK TO HAVE A MINIMUM COMPRESSION STRENGTH OF 7.5N/mm² S7.5 TO BS 1100.
- CAVITY WALL TIES TO BE SS STRIP TYPE WALL TIES AT 750mm c/c HORIZONTALLY AND 450mm c/c VERTICALLY. AT CONTROL JOINTS AND AROUND OPENINGS TIES TO BE PROVIDED AT 225mm VERTICAL CENTRES.
- ALL STRUCTURAL TIMBER TO BE GRADE C16 TO IS44 OR BETTER.
- ALL REINFORCEMENT TO BE INSPECTED BY ENGINEER PRIOR TO POURING OF CONCRETE.
- IT IS THE CONTRACTOR'S RESPONSIBILITY TO VERIFY OR DETERMINE ALL DIMENSIONS AND LEVELS REQUIRED PRIOR TO COMMENCEMENT OF CONSTRUCTION OR PRODUCTION OF FABRICATION DRAWINGS.
- FOR ALL SETTING OUT, REFER TO ARCHITECT'S DETAILS.
- PERISHABLE COMPRESSIBLE FILLER BOARD IS NOT TO BE USED.
- THE CONTRACTOR IS RESPONSIBLE FOR ALL TEMPORARY WORKS REQUIRED IN ORDER TO CONSTRUCT THE BUILDING, WHILST MAINTAINING OVERALL STABILITY.
- ALL PRECAST CONCRETE ELEMENTS TO BE CONSTRUCTED IN ACCORDANCE WITH SPECIALIST SUB-CONTRACTOR'S DETAILS AND SPECIFICATIONS.
- THE FORMATION FOR ALL FOUNDATIONS IS TO BE INSPECTED BY THE ENGINEER PRIOR TO THE POURING OF ANY CONCRETE. THE CONTRACTOR SHALL NOT EXCAVATE BELOW FORMATION LEVEL WITHOUT PRIOR WRITTEN INSTRUCTION FROM THE ENGINEER.
- ALL MATERIAL & WORKMANSHIP TO BE IN ACCORDANCE WITH ENGINEER'S SPECIFICATIONS.
- ALL BACKFILL MATERIAL SHALL COMPLY WITH THE PROVISIONS OF SR21 AND I.S. EN 12422:2002. TESTING SHALL BE CARRIED OUT BY THE CONTRACTOR AT THE SOURCE OF ANY MATERIAL PROPOSED AS FILL TO VERIFY THE MATERIAL COMPLIES WITH THE GUIDANCE GIVEN IN SR21. WRITTEN CONFIRMATION ON COMPLIANCE MUST BE ISSUED BY THE CONTRACTOR PRIOR TO ARRIVAL OF MATERIAL ON SITE.
- ALL BLOCKWORK / CONCRETE INTERFACES TO BE TIED USING STAINLESS STEEL WALL TIES AT 225mm SPACING (VERT.).
- ALL INSULATION, DPC & RADON DETAILS TO ARCHITECT'S SPECIFICATIONS.
- REFER TO PRECAST SUPPLIER FOR PRECAST FLOOR PROPPING REQUIREMENTS.
- ALL PRECAST CONCRETE UNITS TO HAVE 100mm MIN. BEARING ONTO MASONRY WALLS/CONCRETE BEAMS/CONCRETE WALLS.
- USE JOIST HANGERS AT ALL TIMBER TO TIMBER JOINTS.
- BOTTOM OF TRENCHES TO BE CLEANED AND SIGNED OFF BY ENGINEER PRIOR TO THE POURING OF ANY CONCRETE.
- CONCRETE TRENCH FILL UNDER FOUNDATION STRIPS TO BE C20/25.
- ALL FOUNDATIONS TO BE FOUNDED ON FIRM VIRGIN GROUND.
- ALL WALLS TO BE LOCATED CENTRALLY ON FOUNDATIONS (U.N.O.).
- ALL ROOF BRACING TO SPECIALIST TIMBER TRUSS DESIGNERS DESIGN & SPECIFICATION.
- ALL WORKS CARRIED OUT MUST COMPLY WITH THE RELEVANT PARTS OF THE CURRENT BUILDING REGULATIONS AND TECHNICAL GUIDANCE DOCUMENTS ENSURING THE WORKS ARE CARRIED OUT USING PROPER MATERIALS WHICH ARE FIT FOR USE FOR WHICH THEY ARE INTENDED AND FOR THE CONDITIONS IN WHICH THEY ARE TO BE USED.
- ALL MATERIALS USED SHALL BE (CE) MARKED IN ACCORDANCE WITH THE EU CONSTRUCTION PRODUCT REGULATIONS (CPR) (No. 305/2011). REFER TO ANNEX IV OF THE REGULATIONS FOR THE LIST OF APPLICABLE PRODUCTS. ALL MATERIALS USED SHALL BE (CE) MARKED IN ACCORDANCE WITH THE EU CONSTRUCTION PRODUCT REGULATIONS (CPR) (No. 305/2011). REFER TO ANNEX IV OF THE REGULATIONS FOR THE LIST OF APPLICABLE PRODUCTS.
- REFER TO PILING SPECIFICATION FOR TESTING REQUIREMENTS.

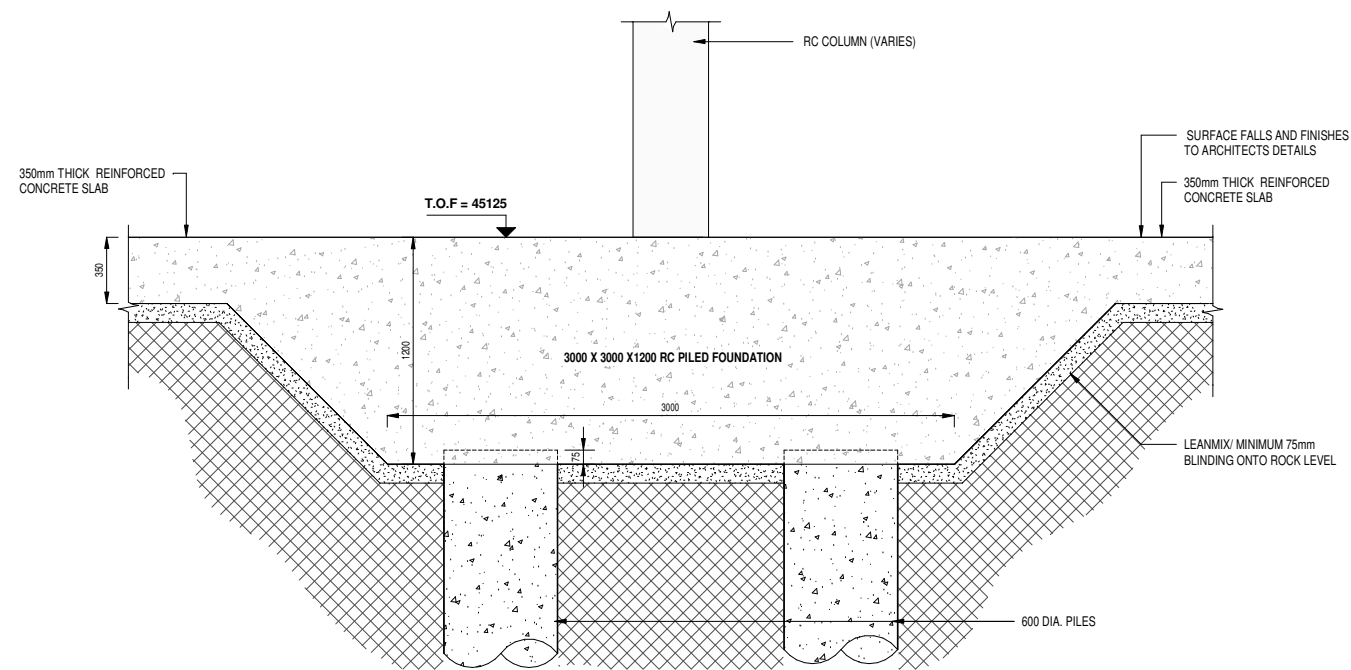

F-01 - TYPICAL PILE FOUNDATION DETAIL THROUGH PC03
SCALE 1:20

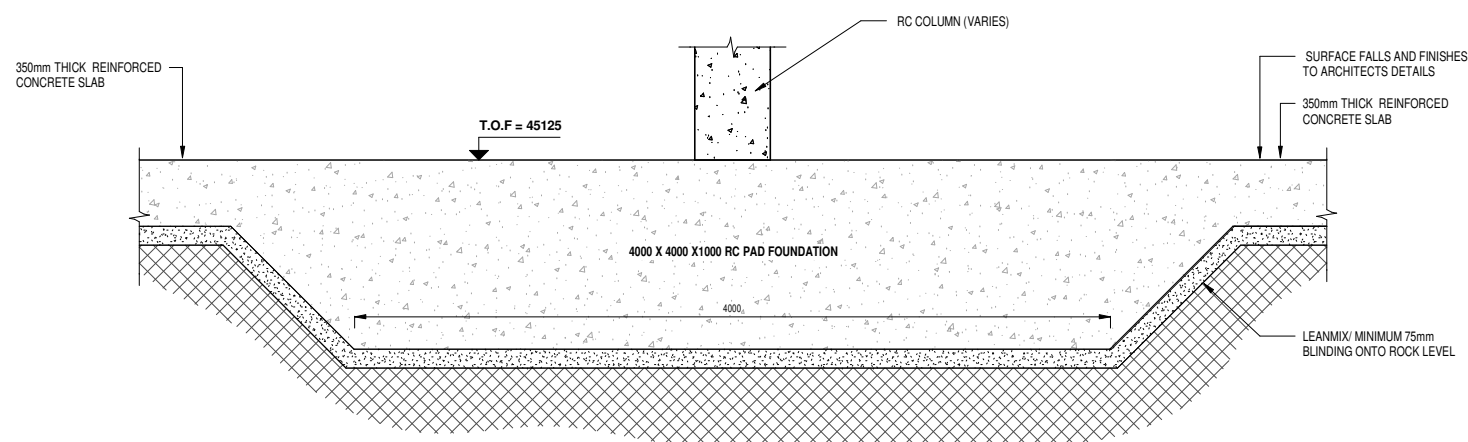

F-02 - TYPICAL PAD FOUNDATION DETAIL THROUGH P04
SCALE 1:20

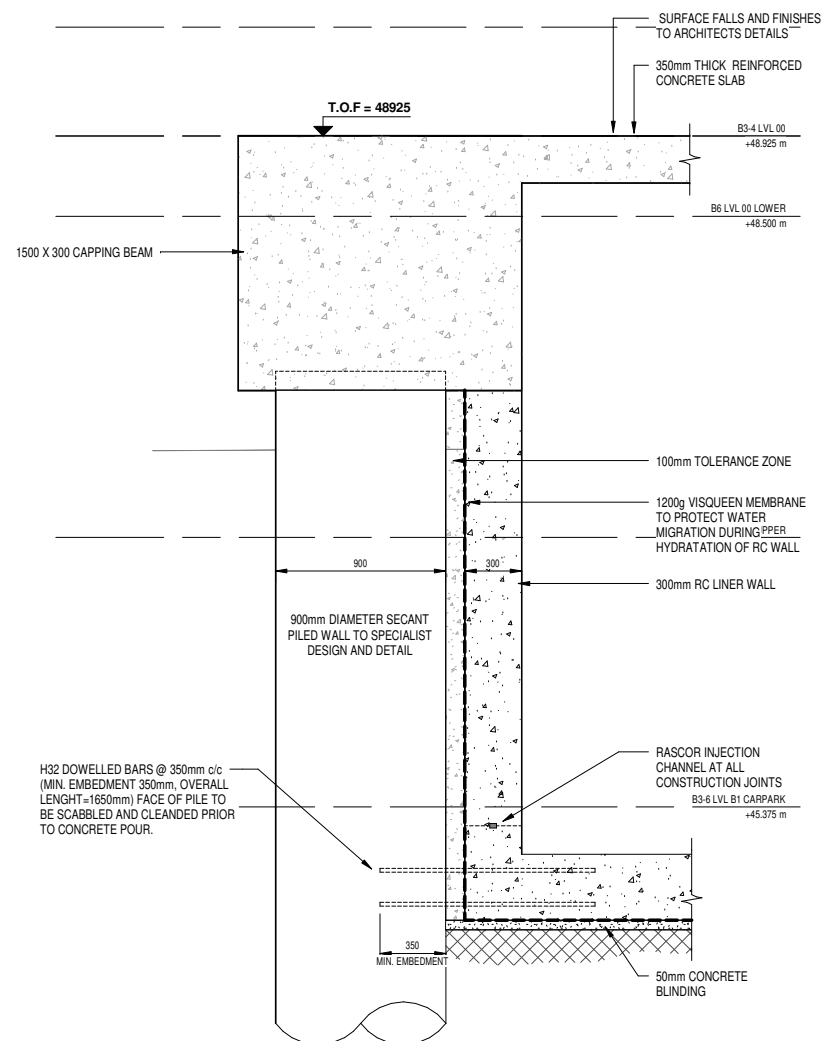

F-03 - TYPICAL SECTION THROUGH PILED WALL
SCALE 1:20

Rev	Date	Description	Drawn By	Checked By
Amendments				

Project: **BLAKES RESIDENTIAL**

Title: **FOUNDATIONS
BLOCK 1&2
TYPICAL SECTIONS**

Client: **CAIRN HOMES**

Architect: **O'MAHONY PIKE**

Waterman Moylan
Engineering Consultants

Block S East Point Business Park Dublin D03 H3F4
t +353 1 664 8900
info@moylan.ie www.waterman-moylan.ie

Status: **PRELIMINARY**

Drawn By	Designed By	Checked By	Approved By
DB	AB	AB	AB

Waterman Moylan Ref: 20-071 Date: 24.03.22 Scales @ A1: 1:20

Project	Originator	Volume	Level	Type	Rate	Number	Revision
20-071-WMS-A-FO-DR-S-21301							P01