

Ashgrove House
26 Foxrock Court
Dublin 18
D18 R2K1

Mob. 086-3819011
e-mail - thetreefile@eircom.net

Graphic Representation of Tree Form, balance and Protection Zone

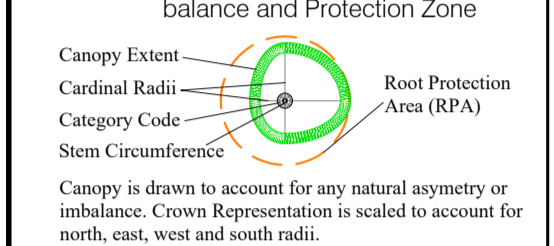

Canopy is drawn to account for any natural asymmetry or imbalance. Crown Representation is scaled to account for north, east, west and south radii.
Root Protection Area (RPA)
This area relates the "RPA" radius as defined in the Tree Survey Table and is measured from the tree centre.
This area defines the preliminary Construction Exclusion Zone (CEZ) that must be protected by fencing from the potentially damaging affects of construction activity.

Tree Quality (Categorisation)

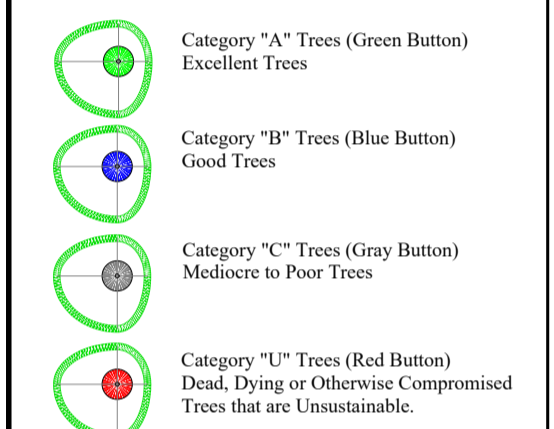

Tree Retention

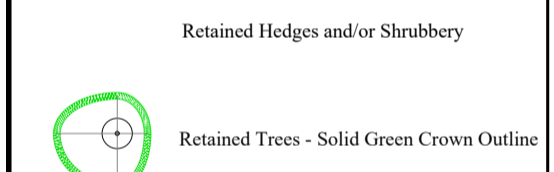

Tree Protection Measures and Extent

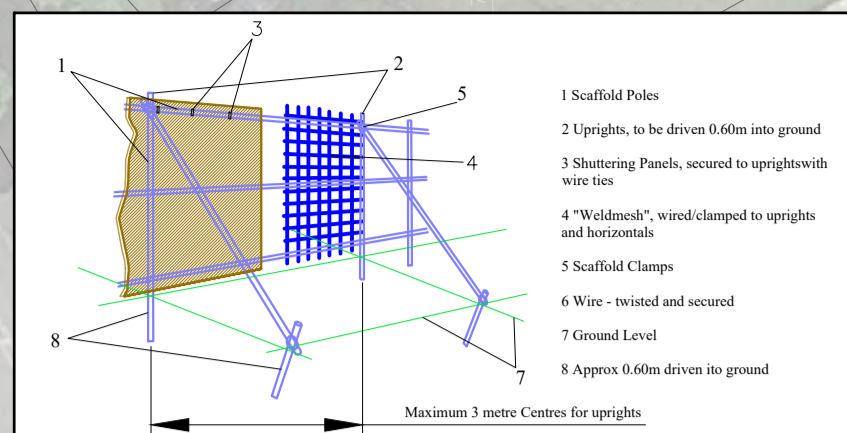
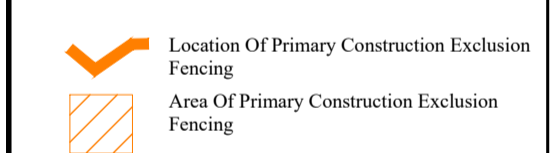

Example of Construction Methodology for "Construction Exclusion Fencing".

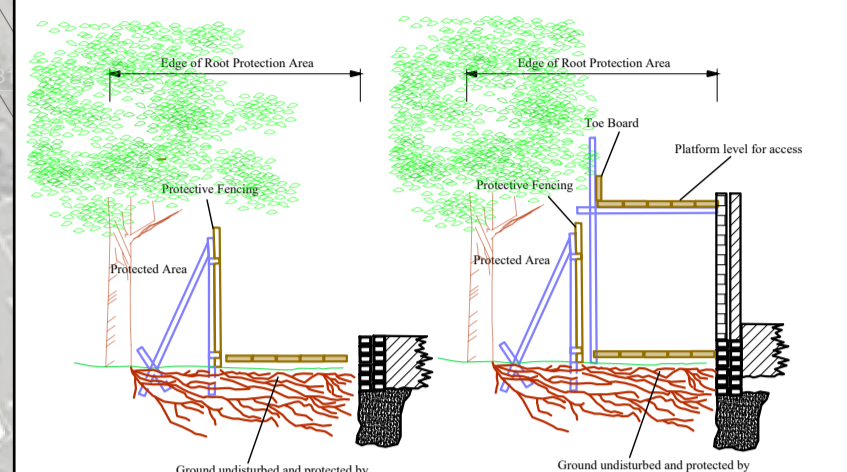

Scaffolding (and Extended Work Space) Within Protection Zones

Cellular Confinement Systems can provide robust ground protection that can provide access for larger plant and machinery but must be installed in accordance with manufacturers specification and to engineers requirements.

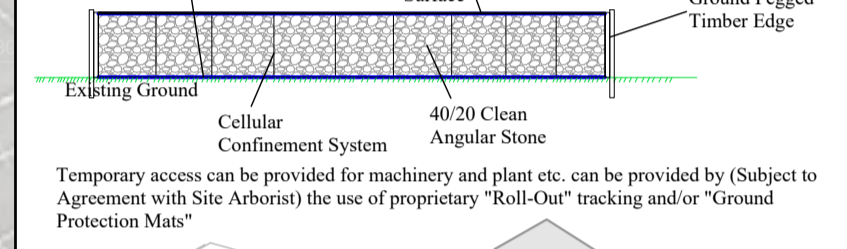

Temporary access can be provided for machinery and plant etc. can be provided by (Subject to Agreement with Site Arborist) the use of proprietary "Roll-Out" tracking and/or "Ground Protection Mats".

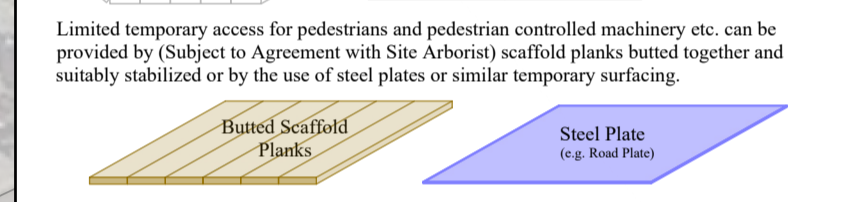

Limited temporary access for pedestrians and pedestrian controlled machinery etc. can be provided by (Subject to Agreement with Site Arborist) scaffold planks butted together and suitably stabilized or by the use of steel plates or similar temporary surfacing.

Each of the above must be installed on a progressive, rolling-out basis, with access only being gained from previously protected ground.
The ground beneath such systems must be protected by the use of a "Geotextile" membrane and a layer of "Compression Resistant" material (e.g. wood chips).

Examples of Ground Protection Systems

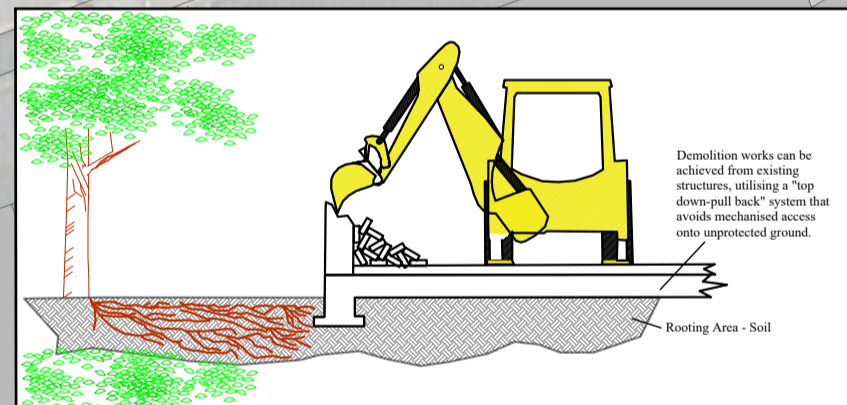

Mechanised Works Within Protection Zones

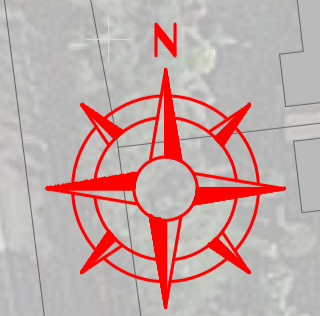

This Drawing Must Be Read in Conjunction with the "Arboricultural Method Statement" at "Appendix 1" of the Associated Arboricultural Report

Client: Cairn Homes Properties Limited
Scale: 1:500 @ A1 Date: March 2022
Project: Tree Survey, Blake's Residential Development Stillorgan, Co Dublin
Description: Tree Protection Plan
Drawing Title: Blake's Tree Protection Plan